

## N320

Sizes 2" – 10"



### Description

This heavy-duty globe valve complies with API and BS standards. The seat ring and wedge disc are precision-ground and lapped to achieve mirror-like finishes, ensuring optimal sealing surfaces. A plug-type disc is standard, with flat and regulating discs available upon request.

The heat-treated stainless steel stem features precision-machined ACME threads for extended service life. A machined backseat bushing provides a secondary metal-to-metal stem seal. The rising stem clearly indicates the valve's open/closed position, and the large-diameter handwheel allows for easy operation.

The yoke sleeve is constructed from austenitic ductile iron, offering excellent resistance to heat, corrosion, and wear. A two-piece, self-aligning gland bushing and gland flange prevent damage, reinforced by high-strength alloy steel stud bolts.

- **Design: API 6D**
- **Shell Design: ASME B16.34 (Valves – Flanged, Threaded, and Welding End)**
- **Flanged Ends: ANSI B16.5**
- **Face to Face: ANSI B16.10**
- **Testung: API 598**

For information please contact us:  
[info@newcomen.de](mailto:info@newcomen.de)  
 (+49) 21511528392

## Cryogenic Ball Valve API 6D Class 150-600

- **Full and Reduced bore**
- **Hand and Gear Wheel Operated (Actuation Available)**
- **Split body 2-3 pieces or 1 piece (side or top entry)**
- **Full bore or reduced bore**
- **Self-cavity pressure relief**
- **Low emission design**
- **High-Pressure and High-Temperature Capabilities**
- **Double Block and Bleed (DBB) Capability**
- **Fire-Safe & Anti-Static Design (if required)**



### Beschreibung

Konstruiert nach API 6D und druckgeprüft gemäß API 598/EN 12266-1, bietet dieses robuste Flansch-Absperrventil hervorragende Langlebigkeit für anspruchsvolle industrielle Anwendungen, Kesselanlagen und raue Umgebungen. Das Ventil ist mit ANSI 150 Flanschen erhältlich und gewährleistet durch ein robustes Handrad eine maximale Lebensdauer.



### Description

Designed to API 6D and pressure tested according to API 598/EN 12266-1, this robust flanged gate valve offers exceptional durability for demanding industrial applications, boiler systems, and harsh environments. Available with ANSI 150 flanges, the valve ensures maximum service life through a sturdy handwheel.

## Two-Piece, Cast Cryogenic Standard Bore

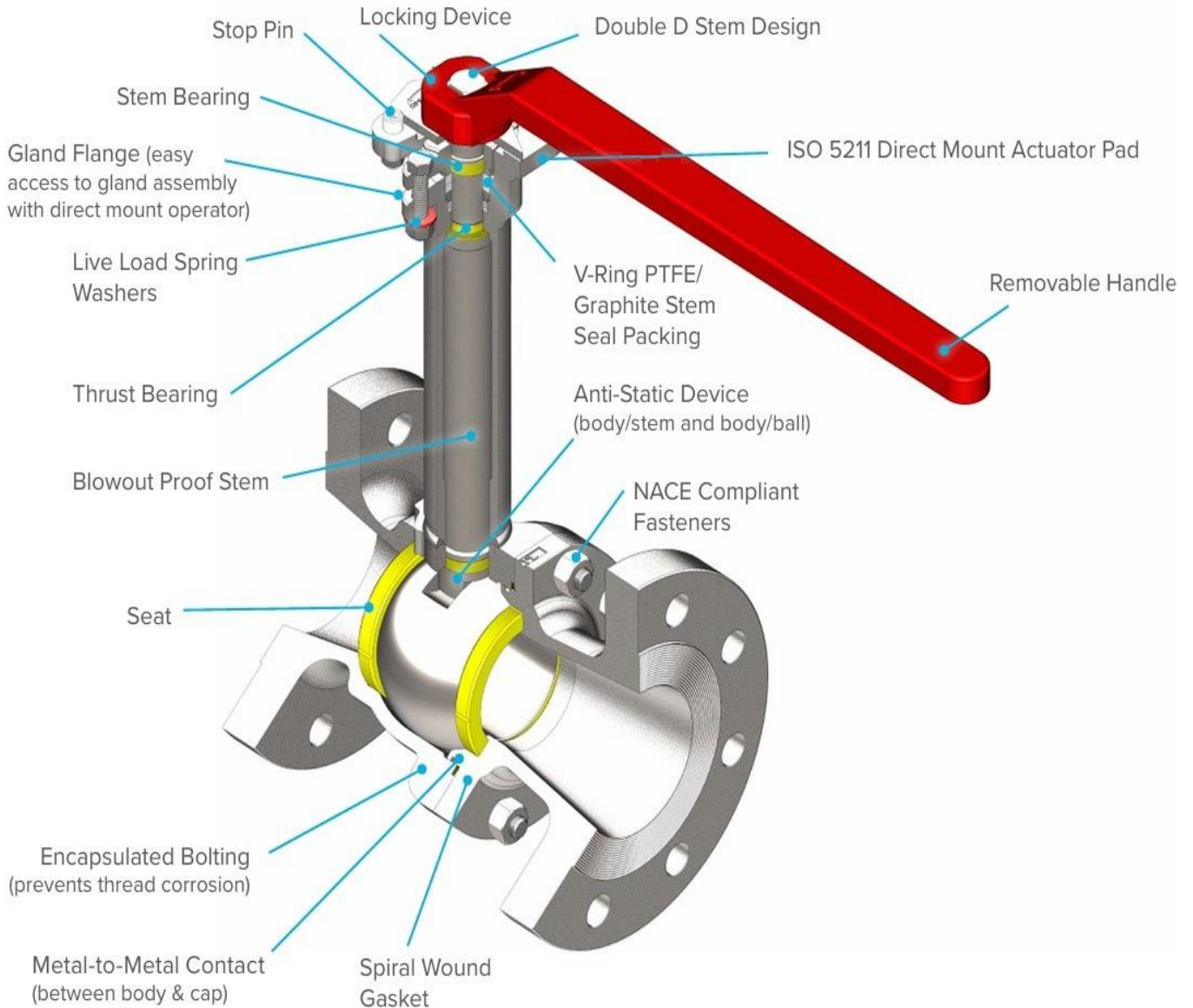

- API 608, ASME B16.34, API 607
- Tested in accordance to API 598
- Integrally cast extension on select sizes
- Class 150–600
- Double D and square stem available
- Dual V-ring PTFE/Graphite stem packing to meet API 607

## Two-Piece, Cast Cryogenic Full Bore

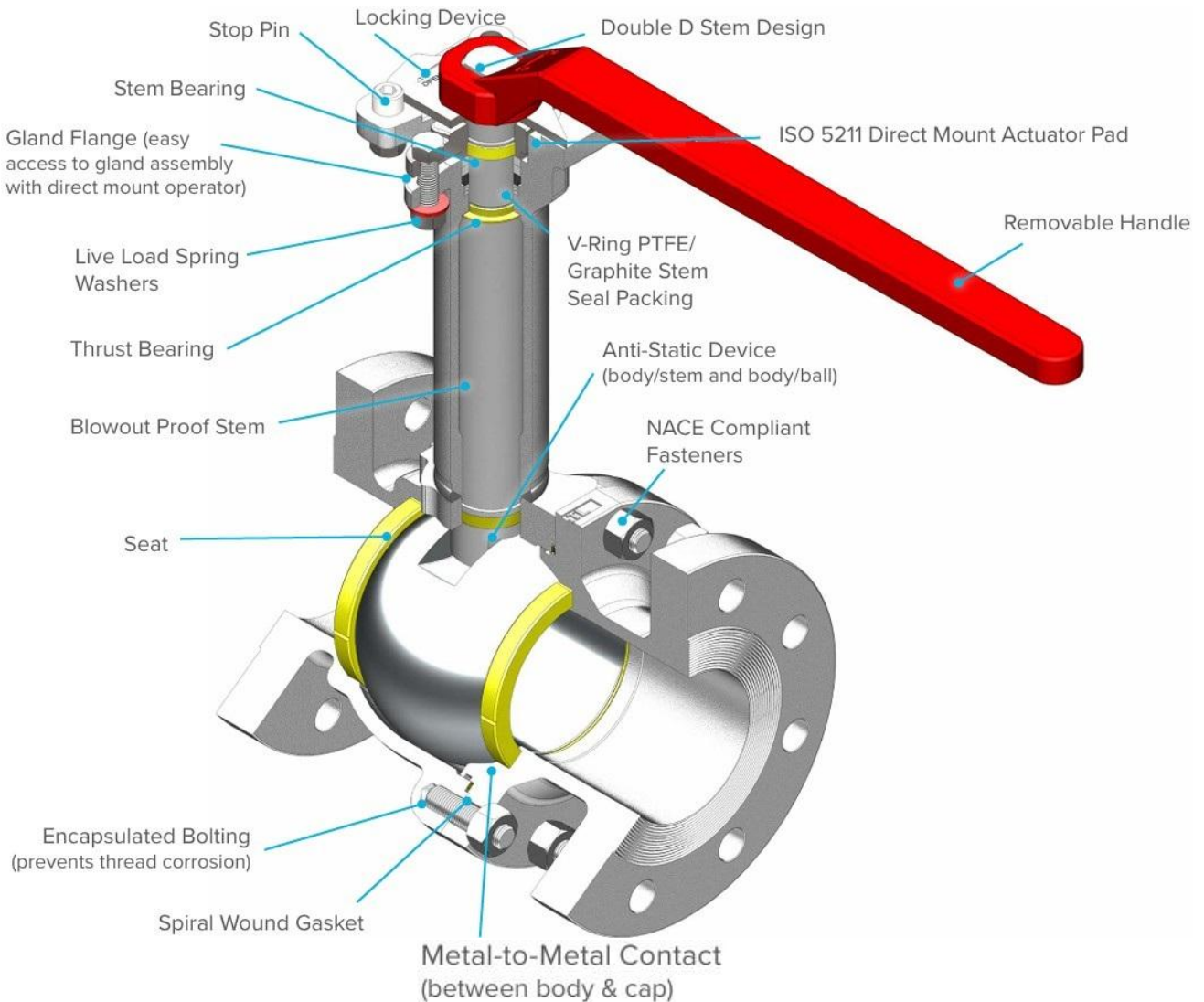

- API 608, ASME B16.34, API 607
- Tested in accordance to API 598
- Optional non-cold box and cold-box testing per MSS SP-134
- Integrally cast extension on select sizes
- Class 150 – 600
- Double D and square stem available
- Dual V-ring PTFE/Graphite stem packing to meet API 607

**Two-Piece, Cast Cryogenic Standard Bore**

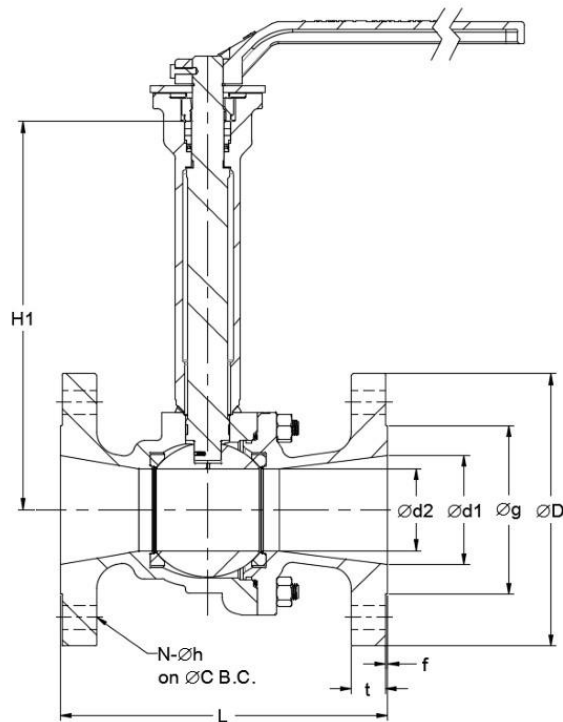

150	d1:ln	d2:ln	L:ln	H1:ln	D:ln	C:ln	g:ln	t:ln	f:ln	N:ln	h:ln
2"	2	1,5	7	10,31	6	4,75	3,63	0,56	0,06	4	0,75
3"	3	2	8	13,25	7,5	6	5	0,69	0,06	4	0,75
4"	4	3	9	14,25	9	7,5	6,19	0,88	0,06	4	0,75
6"	6	4	15,5	17,26	11	9,5	8,5	1	0,06	8	0,88

300	d1:ln	d2:ln	L:ln	H1:ln	D:ln	C:ln	g:ln	t:ln	f:ln	N:ln	h:ln
2"	2	1,5	8,5	10,31	6,5	5	3,63	0,81	0,06	8	0,75
3"	3	2	11,12	13,25	8,25	6,62	5	1,06	0,06	8	0,75
4"	4	3	12	14,25	10	7,88	6,19	1,19	0,06	8	0,75
6"	6	4	15,87	17,26	12,5	10,62	8,5	1,38	0,06	12	0,88

600	d1:In	d2:In	L:In	H1:In	D:In	C:In	g:In	t:In	f:In	N:In	h:In
2"	2	1,5	11,5	10,31	6,5	5	3,63	1	0,25	8	0,75
3"	3	2	14	13,25	8,25	6,62	5	1,25	0,25	8	0,88
4"	4	3	17	14,25	10,75	8,5	6,19	1,5	0,25	8	1
6"	6	4	22	17,26	14	11,5	8,5	1,88	0,25	12	1,12

Two-Piece, Cast Cryogenic Full Bore

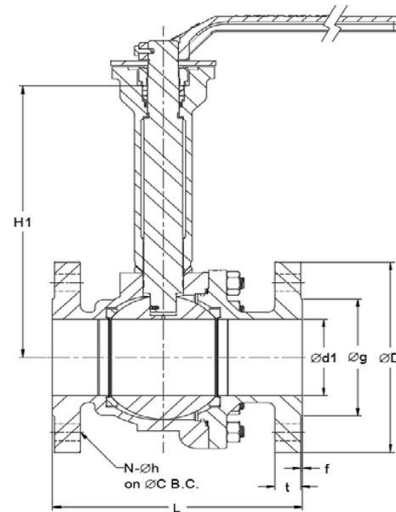
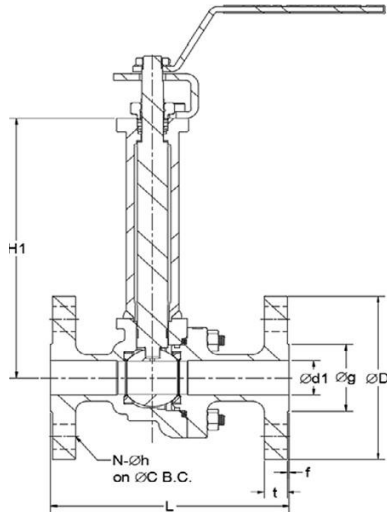

150	d1:In	L:In	D1:In	H1:In	D:In	C:In	g:In	t:In	f:In	N:In	h:In
2"	2	7	10,26	16	6	4,75	3,63	0,56	0,06	4	0,75
3"	3	8	13,25	18	7,5	6	5	0,69	0,06	4	0,75
4"	4	9	14,31	22	9	7,5	6,19	0,88	0,06	8	0,75
6"	6	15,5	17,25	24	11	9,5	8,5	0,94	0,06	8	0,88
8"	8	18	18,41	27	13,5	11,75	10,62	1,06	0,06	8	0,88
10"	10	21	25,37	32	16	14,25	12,75	1,12	0,06	12	1

300	d1:ln	L:ln	D1:ln	H1:ln	D:ln	C:ln	g:ln	t:ln	f:ln	N:ln	h:ln
2"	2	8,5	10,26	16	6,5	5	3,63	0,81	0,06	8	0,75
3"	3	11,12	13,25	18	8,25	6,62	5	1,06	0,06	8	0,88
4"	4	12	14,31	22	10	7,88	6,19	1,19	0,06	8	0,88
6"	6	15,88	17,25	24	12,5	10,62	8,5	1,38	0,06	12	0,88
8"	8	19,75	18,41	27	15	13	10,62	1,56	0,06	12	1
10"	10	22,38	25,37	32	17,5	15,25	12,75	1,81	0,06	16	1,13

600	d1:ln	L:ln	D1:ln	H1:ln	D:ln	C:ln	g:ln	t:ln	f:ln	N:ln	h:ln
2"	2	11,5	10,26	16	6,5	5	3,63	1	0,25	8	0,75
3"	3	14	13,25	18	8,25	6,62	5	1,25	0,25	8	0,88
4"	4	17	14,31	22	10,83	8,5	6,19	1,56	0,25	8	1
6"	6	22	17,25	24	14	11,5	8,5	1,88	0,25	12	1,13